

# ISOLATED TEMPERATURE TRANSMITTER HEAD MOUNT

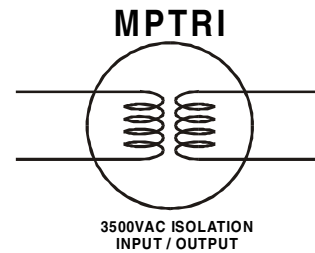

**STANDARD**

- INPUT**
- THERMOCOUPLE J, K, T, E, S, R, N
  - PT100, PT500, PT1000, Ni100, Ni500
  - CUSTOM INPUT 40 POINT LINEARIZE
- OUTPUT** - 4-20mA or 20-4mA
- 0.05% ACCURACY**
- FITS STANDARD T/C HEAD**
- ISOLATION - 3500VAC INPUT / OUTPUT**
- SMALL SPAN CAPABILITY - 10°C**



**DIMENTIONAL DRAWING**

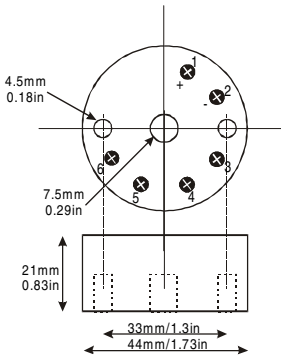

**ELECTRICAL CONNECTION**

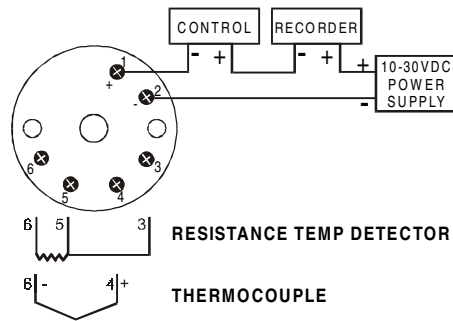

**MODEL CODE**

MPTRI -	<b>INPUT</b>	-	<b>SCALE</b>	-	<b>ERROR</b>
	J		ie. 0-500°F		U - UP (25mA)
	K				L - DOWN(3mA)
	T				
	E				
	S	Pt100			
	R	Pt1000			
	N	OTHER			

**SPECIFICATIONS - MPTRI**

**1. INPUT**

Thermocouple	J, K, T, E, R, S, N
RTD	Pt100, Pt500, Pt1000, Ni100, Ni500, Ni1000
mV	CUSTOM RANGES
Range	Full Sensor Ranges
Accuracy	0.05% of SPAN
CJC Comp Accuracy	+/-1°C
Zero Range	-50 to +50°C

**3. ENVIRONMENTAL**

Operating Temp.	-40 - 85°C / -40 - 185°F
Humidity	0 - 95% non Condensing
Rating	IP54 - IN HEAD
Weight	40g

**2. OUTPUT**

Output	4-20mA or 20-4mA
Temp Stability	+/-0.005% / oC
Response (10-90%)	<0.2s
Long Term Stability	0.1% / YR
Permissible Load	620ohm @ 24VDC
Sensor Break Action	High(25mA) or Low(3mA)
Isolation	3500VAC INPUT/OUTPUT

**4. POWER**

Rating	8 - 35VDC
--------	-----------